

Chapter 8 Giacomini big size valves ,
with cast iron body and flanged connections ,
are suitable for a full range of solutions
among heating, cooling and balancing systems.
They are designed for water applications

And complete the family of Giacomini
brass valves for high flow installation.



Valves with flanged connections

Products

194 Valves with flanged connections

Valves with flanged connections

R55FL

PRODUCT CODE	SIZE		
R55FLY005	DN50	1	-
R55FLY006	DN65	1	-
R55FLY008	DN80	1	-
R55FLY010	DN100	1	-
R55FLY012	DN125	1	-
R55FLY015	DN150	1	-
R55FLY020	DN200	1	-
R55FLY025	DN250	1	-
R55FLY030	DN300	1	-

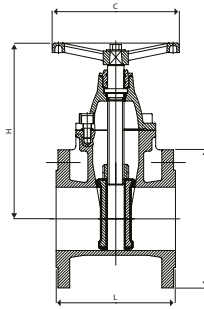

Gate valve with EPDM coated wedge.

MAX. WORKING CONDITIONS WITH WATER

- Max. working temperature: 100 °C
- Max. working pressure: 16 bar
- Max. working pressure (continuous): 11 bar

APPLICABLE EU DIRECTIVES

- Fluids of use: group 2 - liquid (2014/68/EU PED)

PRODUCT CODE	L	H	D	C
R55FLY005	150	197	165	160
R55FLY006	170	228	185	200
R55FLY008	180	254	200	200
R55FLY010	190	281	220	200
R55FLY012	200	340	250	250
R55FLY015	210	378	285	250
R55FLY020	230	460	340	320
R55FLY025	250	563	400	366
R55FLY030	270	643	455	366

R59FL

BUTTERFLY VALVE WITH DUAL STEM - STAINLESS STEEL DISC

PRODUCT CODE	SIZE		
R59FLY004	DN40	1	-
R59FLY005	DN50	1	-
R59FLY006	DN60	1	-
R59FLY008	DN80	1	-
R59FLY010	DN100	1	-
R59FLY012	DN125	1	-
R59FLY015	DN150	1	-
R59FLY020	DN200	1	-
R59FLY025	DN250	1	-
R59FLY030	DN300	1	-



LUG type butterfly valve.

INFO

- * Butterfly valve with gear box - Nickel plated ductile iron disc.

MAX. WORKING CONDITIONS WITH WATER

- Max. working temperature: 120 °C
- Max. working pressure: 16 bar
- Max. working pressure (continuous): 11 bar

APPLICABLE EU DIRECTIVES

- Fluids of use: group 2 - liquid (2014/68/EU PED).

**BUTTERFLY VALVE WITH DUAL STEM
NICKEL PLATED DUCTILE IRON DISC**

PRODUCT CODE	SIZE		
R59FLX004	DN40	1	-
R59FLX005	DN50	1	-
R59FLX006	DN60	1	-
R59FLX008	DN80	1	-
R59FLX010	DN100	1	-
R59FLX012	DN125	1	-
R59FLX015	DN150	1	-
R59FLX020	DN200	1	-
R59FLX025	DN250	1	-
R59FLX030	DN300 *	1	-
R59FLX035	DN350 *	1	-
R59FLX040	DN400 *	1	-
R59FLX045	DN450 *	1	-
R59FLX050	DN500 *	1	-
R59FLX060	DN600 *	1	-

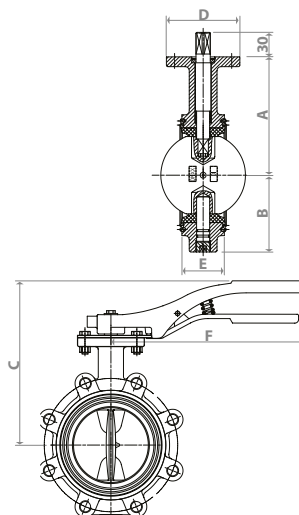

PRODUCT CODE	A	B	E	D	F	C
R59FLY004	140	63,5	34,5	90	260	217
R59FLY005	140	63,5	43	90	260	217
R59FLY006	152	76	45	90	260	229
R59FLY008	160	85	46	90	260	237
R59FLY010	180	100	51,5	90	260	257
R59FLY012	191	120	56	90	260	268
R59FLY015	202	132	56,5	90	260	279
R59FLY020	237	160	60	125	326	336
R59FLY025	274	200	68,5	125	416	376
R59FLY030	312	230	79,5	125	416	414

R59W

BUTTERFLY VALVE WITH DUAL STEM - STAINLESS STEEL DISC

PRODUCT CODE	SIZE		
R59WY004	DN40	1	-
R59WY005	DN50	1	-
R59WY006	DN65	1	-
R59WY008	DN80	1	-
R59WY010	DN100	1	-
R59WY012	DN125	1	-
R59WY015	DN150	1	-
R59WY020	DN200	1	-
R59WY025	DN250	1	-
R59WY030	DN300	1	-

BUTTERFLY VALVE WITH DUAL STEM NICKEL PLATED DUCTILE IRON DISC

PRODUCT CODE	SIZE		
R59WX004	DN40	1	-
R59WX005	DN50	1	-
R59WX006	DN65	1	-
R59WX008	DN80	1	-
R59WX010	DN100	1	-
R59WX012	DN125	1	-
R59WX015	DN125	1	-
R59WX020	DN200	1	-
R59WX025	DN250	1	-
R59WX030	DN300	1	-
R59WX035	DN350 *	1	-
R59WX040	DN400 *	1	-
R59WX045	DN450 *	1	-
R59WX050	DN500 *	1	-
R59WX060	DN600 *	1	-

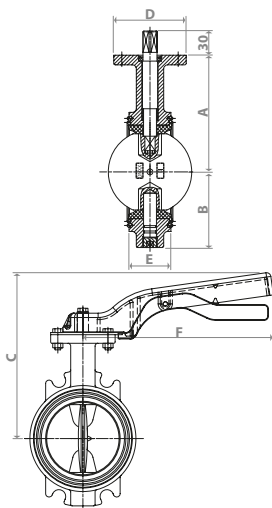

Wafer type butterfly valve.

INFO

* Butterfly valve with gear box - Nickel plated ductile iron disc

MAX. WORKING CONDITIONS WITH WATER

- Max. working temperature: 120 °C
- Max. working pressure: 16 bar
- Max. working pressure (continuous): 11 bar

APPLICABLE EU DIRECTIVES

- Fluids of use: group 2 - liquid (2014/68/EU PED).

PRODUCT CODE	A	B	C	D	E	F
R59WY004	140	63,5	217	90	34,5	260
R59WY005	140	63,5	217	90	43	260
R59WY006	152	76	229	90	45	260
R59WY008	160	85	237	90	46	260
R59WY010	180	100	257	90	51,5	260
R59WY012	191	120	268	90	56	260
R59WY015	202	132	279	90	56,5	260
R59WY020	237	160	336	125	60	326
R59WY025	274	200	376	125	68,5	416
R59WY030	312	230	414	125	79,5	416

R60W

PRODUCT CODE	SIZE		
R60WY000	DN15	1	-
R60WY001	DN20	1	-
R60WY002	DN25	1	-
R60WY003	DN32	1	-
R60WY004	DN40	1	-
R60WY005	DN50	1	-
R60WY006	DN65	1	-
R60WY008	DN80	1	-
R60WY010	DN100	1	-

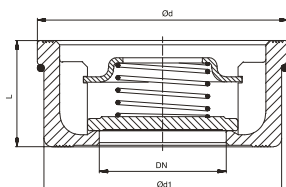

Brass body disc type check valve.

MAX. WORKING CONDITIONS WITH WATER



- Max. working temperature: 120 °C
- Nominal pressure: 16 bar
- Max. working pressure (continuous): 11 bar

APPLICABLE EU DIRECTIVES

- Fluids of use: group 2 - liquid and gases (2014/68/EU PED)

PRODUCT CODE	L	Ød	Ød1
R60WY000	16	40	15
R60WY001	19	47	20
R60WY002	22	56	25
R60WY003	28	72	32
R60WY004	31,5	82	39
R60WY005	40	95	48
R60WY006	46	115	64
R60WY008	50	132	74
R60WY010	60	152	89

R74OFL

PRODUCT CODE	SIZE		
R74OFLY004	DN40	1	-
R74OFLY005	DN50	1	-
R74OFLY006	DN65	1	-
R74OFLY008	DN80	1	-
R74OFLY010	DN100	1	-
R74OFLY012	DN125	1	-
R74OFLY015	DN150	1	-
R74OFLY020	DN200	1	-



Full bore ball valve with stainless steel ball.

MAX. WORKING CONDITIONS WITH WATER

- Max. working temperature: 120 °C
- Max. working pressure: 16 bar
- Max. working pressure (continuous): 11 bar

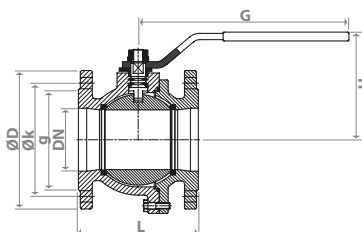

APPLICABLE EU DIRECTIVES

- Fluids of use: group 2 - liquid (2014/68/EU PED)



PRODUCT CODE	L	ØD	ØK	g	H	G
R74OFLY004	140	150	110	84	120	190
R74OFLY005	150	165	125	99	130	260
R74OFLY006	170	185	145	118	140	260
R74OFLY008	180	200	160	132	155	335
R74OFLY010	190	220	180	156	170	335
R74OFLY012	325	250	210	184	190	335
R74OFLY015	350	285	240	211	245	700
R74OFLY020	400	340	295	266	280	700

R74FL

PRODUCT CODE	SIZE		
R74FLY005	DN50	1	-
R74FLY006	DN65	1	-
R74FLY008	DN80	1	-
R74FLY010	DN100	1	-
R74FLY012	DN125	1	-
R74FLY015	DN150	1	-
R74FLY020	DN200	1	-
R74FLY025	DN250	1	-
R74FLY030	DN300	1	-



Strainer with stainless steel screen, epoxy painted.

MAX. WORKING CONDITIONS WITH WATER

- Max. working temperature: 120 °C
- Max. working pressure: 16 bar
- Max. working pressure (continuous): 11 bar

APPLICABLE EU DIRECTIVES

- Fluids of use: group 1 & 2 - liquid and gases (2014/68/EU PED)

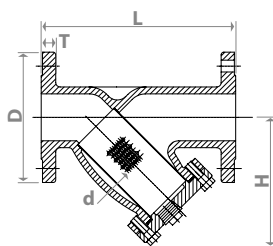

PRODUCT CODE	L	H	D	T	d	Pulg (BSPT)
R74FLY005	230	130	165	17	Ø 1,5	1/2"
R74FLY006	290	156	185	17	Ø 1,5	1"
R74FLY008	310	172	200	17	Ø 1,5	1"
R74FLY010	350	215	220	17	Ø 3	1"
R74FLY012	400	240	250	17	Ø 3	1 1/4"
R74FLY015	480	282	285	17	Ø 3	1 1/2"
R74FLY020	600	335	340	18	Ø 3	1 1/2"
R74FLY025	730	460	400	20	Ø 3	2"
R74FLY030	850	515	455	22,5	Ø 3	2"

R206B

PRODUCT CODE	SIZE		
R206BY205	DN50	1	-
R206BY206	DN65	1	-
R206BY208	DN80	1	-
R206BY210	DN100	1	-
R206BY212	DN125	1	-
R206BY215	DN150	1	-
R206BY220	DN200	1	-
R206BY225	DN250	1	-
R206BY230	DN300	1	-



Cast iron static balancing valve. With stainless steel disc, flanged connections and 1/4"F plug for differential pressure measure. Suitable for application with water -10÷120 °C, PN16.

INFO

- Accessories
 - P206Y001: probe holder.
 - R225EY001: differential manometer.

R206B flanged valves are available by checking the conditions of supply with our sales managers.

MAX. WORKING CONDITIONS WITH WATER

- Max. working temperature: 120 °C
- Nominal pressure: 16 bar
- Max. working pressure (continuous): 11 bar

[KV] VALUES

R206BY205:	48,50
R206BY206:	74,40
R206BY208:	111,00
R206BY210:	165,00
R206BY212:	242,00
R206BY215:	372,00
R206BY220:	704,00
R206BY225:	812,00
R206BY230:	1380,00

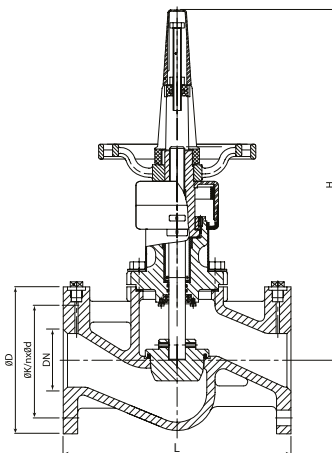

PRODUCT CODE	L	H	ØD	ØK	N x Ød
R206BY205	230	280	160	125	4 x 18
R206BY206	290	365	185	145	4 x 18
R206BY208	310	395	200	160	8 x 18
R206BY210	350	430	220	180	8 x 18
R206BY212	400	495	250	210	8 x 18
R206BY215	480	530	285	240	8 x 22
R206BY220	600	665	340	295	8 x 22
R206BY225	730	600	405	355	12 x 22
R206BY230	850	685	460	410	12 x 26